

COMMUNITY UPDATE

The MTA Long Island Rail Road (LIRR) strives to be a good neighbor in the communities we serve by keeping residents informed of important infrastructure improvements.

Construction of Phase 1 Double Track Project, between Ronkonkoma Ave (Ronkonkoma) and Islip Ave (Central Islip), is underway and will continue until September 2016. The early construction phase which we are still in, consists of clearing, grading, moving earth along the LIRR Right of Way (ROW), and the installation of retaining walls in some locations to support the track structure.

Construction Activities

The following has been completed or is in process during this phase of construction:

- Established fenced staging areas for contractor field offices, equipment and supplies, including stockpile materials.
- Privacy screens have been installed on fencing adjacent to non-LIRR property owners.
- Installed fencing along the ROW.
- Limited clearing of vegetation along the ROW to create a roadway for construction vehicles, reducing the use of construction vehicles on local residential streets.
- Restoring and seeding staging areas along residential properties when construction is complete has been designed into the overall plan.
- Dump trucks and excavators have been working along the ROW removing excess material off the site, and bringing clean fill materials on site.
- Relocation of utilities along and adjacent to the LIRR's right-of way continues.
- Installation of steel sheeting and retaining wall construction adjacent to the ROW has begun in area west of Central Islip Station and will continue east to Veteran's Memorial Highway.

Community Impacts

- For the next six months of construction, the majority of the work will take place during daytime hours.
- Construction will take place within the LIRR's existing property.
- Modification and rehabilitation of the pedestrian overpass adjacent to Helen B. Duffield Elementary School is planned for the overnight hours from Friday 9-26-14 to Saturday 9-27-14
- The LIRR will make every effort to minimize our construction presence by limiting the movement and parking of construction equipment vehicles in residential areas and minimizing noise and vibrations by complying with local regulations and codes.
- This work will occur at many locations at once along the project.

Project Benefits

- The Double Track project will add a second track to 12.6 miles of the mostly single track route that currently exists between Farmingdale to Ronkonkoma.
- Benefit new residential and commercial development around train stations:
 - Projects under development include: Wyandanch, Deer Park, Ronkonkoma
 - Supports redevelopment of village centers and areas around existing LIRR stations
- Service Enhancements:
 - Allows for Half-Hourly, Off-Peak Service in both directions
 - More choices for those who commute between stations on Long Island
 - Better train service to/from Long Island MacArthur Airport
 - Increased Reverse Peak Service

For more information, please visit mta.info/lirr/doubletrack or contact: Hector Garcia / hgarcia@lirr.org / 718-558-7305

Easton Street Road Closure

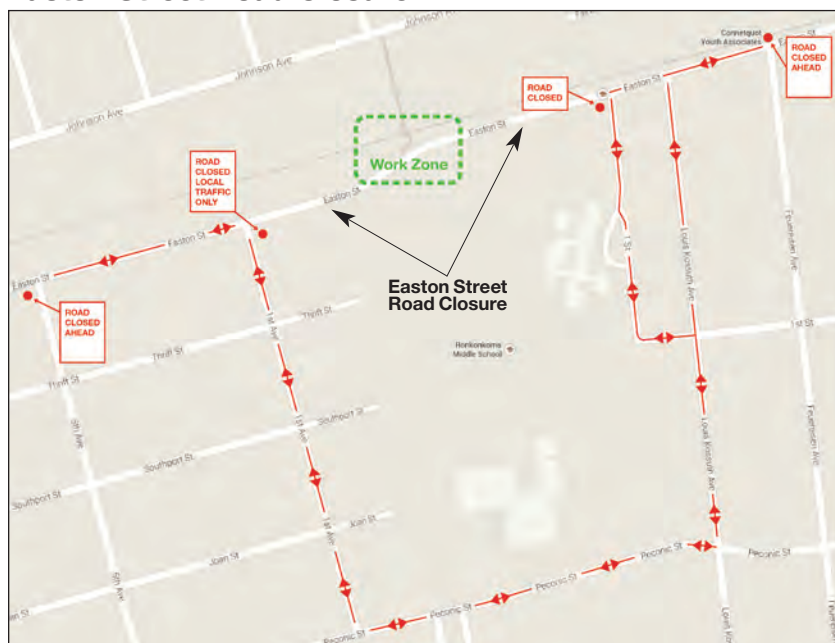

Dates:

10 PM on Friday, September 26 to
8 AM on Saturday, September 27

A single local overnight road closure of Easton Street adjacent to Helen B. Duffield Elementary School will be required to support modifications to the pedestrian overpass. LIRR personnel will be on site to ensure public safety and to maintain proper traffic control.



Detour



Location of Traffic Sign



Work Zone (No Traffic Allowed)