

**Bus Timetable**  
**Effective Summer 2018**



MTA Bus Company

# QM24/QM34

**Express Service – Weekdays Only**



***Between***

***Glendale, Queens, and  
Midtown, Manhattan***

***QM24 - via 6 Av in Midtown***

***QM34 - via 3 Av in Midtown***



If you think your bus operator deserves an Apple Award — our special recognition for service, courtesy and professionalism — call 511 and give us the badge or bus number.

**Fares** – MetroCard® is accepted for all MTA New York City trains (including Staten Island Railway - SIR), and, local, Limited-Stop and +SelectBusService buses (at MetroCard fare collection machines). Express buses only accept 7-Day Express Bus Plus MetroCard or Pay-Per-Ride MetroCard. All of our buses and +SelectBusService Coin Fare Collector machines accept exact fare in coins. Dollar bills, pennies, and half-dollar coins are not accepted.

**Free Transfers** – Unlimited Ride Express Bus Plus MetroCard allows free transfers between express buses, local buses and subways, including SIR, while Unlimited Ride MetroCard permits free transfers to all but express buses. Pay-Per-Ride MetroCard allows one free transfer of equal or lesser value (between subway and local bus and local bus to local bus, etc.) if you complete your transfer within two hours of paying your full fare with the same MetroCard. If you transfer from a local bus or subway to an express bus you must pay an additional \$3.75 from that same MetroCard. You may transfer free from an express bus, to a local bus, to the subway, or to another express bus if you use the same MetroCard. If you pay your local bus fare in coins, you can request a transfer good only on another local bus.

**Reduced-Fare Benefits** – You are eligible for reduced-fare benefits if you are at least 65 years of age or have a qualifying disability. Benefits are available (except on peak-hour express buses) with proper identification, including Reduced-Fare MetroCard or Medicare card (*Medicaid cards do not qualify*).

**Children** – The subway, SIR, local, Limited-Stop, and +SelectBusService buses permit up to three children, 44 inches tall and under to ride free when accompanied by an adult paying full fare.

**Terms and Conditions** – Fares and MetroCard use are subject to applicable tariffs and conditions of use.

## Holiday Service 2018

**Weekday service operates on:** Good Friday, Columbus Day, Veteran's Day (observed).

**Reduced weekday service operates on:** Martin Luther King Day, Day after Thanksgiving (*see Special Schedule at [www.mta.info](http://www.mta.info) - express routes only*).

**Saturday service operates on:** Presidents Day, Independence Day.

**Sunday service operates on:** New Year's Day, Memorial Day, Labor Day, Thanksgiving Day, Christmas Day.

## For More Information



**One MTA  
One Number.**

Call 511 and just say MTA to get the information you need.

TTY/TDD users only . . . . . 711

**Online:** [www.mta.info](http://www.mta.info)

**IF YOU SEE  
SOMETHING,  
SAY  
SOMETHING.**

**Be suspicious  
of anything  
unattended.**

Tell a cop, an MTA employee or call  
1-888-692-7233  
(1-888-NYC-SAFE).

**Filing a Title VI Complaint** – MTA Bus Company is committed to providing non-discriminatory service to ensure that no person is excluded from participation in, or denied the benefits of, or subjected to discrimination in the receipt of its services on the basis of race, color or national origin as protected by Title VI of the Civil Rights Act of 1964 ("Title VI").

To request more information about Title VI or to submit a written complaint if you believe that you have been subjected to discrimination, you may contact NYC Transit's Office of Equal Employment Opportunity, 130 Livingston Street, 3rd Floor, Brooklyn, NY 11201.

In addition to your right to file a complaint with MTA Bus Company, you have the right to file a Title VI complaint with the U.S. Department of Transportation, Federal Transit Administration, Office of Civil Rights, Attention: Complaint Team, East Building 5th Floor – TCR, 1200 New Jersey Avenue SE, Washington, DC 20590.

*Information in this timetable is subject to change without notice. Traffic conditions and weather can affect running time. This timetable was printed with environmentally friendly ink on recycled paper.*

## QM24 Weekday Service (via 6 Av)

From Glendale, Queens, to Midtown, Manhattan

Glendale Myrtle Av/ 73 St	Middle Village Frsh Pnd Rd/ Metropoltn Av	Rego Park Eliot Av/ 85 St	Midtown 34 St/ 3 Av	Midtown 57 St/ 3 Av
6:08	6:23	6:35	6:55	7:13
6:23	6:38	6:50	7:10	7:28
6:38	6:53	7:05	7:25	7:48
6:53	7:08	7:20	7:45	8:08
7:03	7:18	7:32	7:57	8:20
7:13	7:28	7:42	8:07	8:30
7:23	7:42	7:54	8:19	8:42
7:33	7:52	8:04	8:29	8:52
7:43	8:02	8:13	8:38	9:01
7:58	8:17	8:28	8:53	9:16
8:13	8:28	8:39	9:04	9:27
8:28	8:43	8:54	9:19	9:42
8:48	9:03	9:14	9:39	10:02

## QM34 Weekday Service (via 3 Av)

From Glendale, Queens, to Midtown, Manhattan

Glendale Myrtle Av/ 73 St	Middle Village Frsh Pnd Rd/ Metropoltn Av	Rego Park Eliot Av/ 85 St	Midtown 3 Av/ 38 St	Midtown 3 Av/ 55 St
6:05	6:20	6:32	6:52	6:59
6:25	6:40	6:52	7:12	7:19
6:45	7:00	7:12	7:32	7:40
7:00	7:15	7:29	7:54	8:02
7:10	7:25	7:39	8:04	8:12
7:20	7:39	7:51	8:16	8:24
7:30	7:49	8:01	8:26	8:34
7:40	7:59	8:11	8:36	8:44
7:50	8:09	8:20	8:45	8:53
8:10	8:25	8:36	9:01	9:09
8:30	8:45	8:56	9:21	9:29
9:00	9:15	9:26	9:51	9:59

**Bold times denote PM hours.**

**Green-shaded times denote 3 Av service.**

## QM24 Weekday Service (via 6 Av)

From Midtown, Manhattan, to Glendale, Queens

Midtown 34 St/ 3 Av	Midtown 57 St/ 3 Av	Rego Park Eliot Av/ 85 St	Middle Village Frsh Pnd Rd/ Metropoltn Av	Glendale Myrtle Av/ 73 Pl
3:00	3:29	3:49	4:02	4:18
4:00	4:34	4:54	5:07	5:23
4:30	5:04	5:29	5:46	6:02
5:00	5:34	5:59	6:16	6:29
5:30	6:01	6:26	6:37	6:50
6:00	6:31	6:56	7:07	7:20
6:30	6:56	7:21	7:32	7:45
7:00	7:26	7:46	7:57	8:10

## QM34 Weekday Service (via 3 Av)

From Midtown, Manhattan, to Glendale, Queens

Midtown 3 Av/ 38 St	Midtown 3 Av/ 55 St	Rego Park Eliot Av/ 85 St	Middle Village Frsh Pnd Rd/ Metropoltn Av	Glendale Myrtle Av/ 73 Pl
3:30	3:42	4:02	4:15	4:31
4:00	4:12	4:32	4:49	5:05
4:30	4:42	5:07	5:24	5:40
4:45	4:57	5:22	5:39	5:52
5:00	5:12	5:37	5:48	6:01
5:15	5:27	5:52	6:03	6:16
5:30	5:42	6:07	6:18	6:31
5:45	5:57	6:22	6:33	6:46
6:00	6:12	6:37	6:48	7:01
6:20	6:32	6:57	7:08	7:21
6:40	6:48	7:13	7:24	7:37
7:00	7:08	7:28	7:39	7:52

## QM24 Bus Stops to Manhattan

### Stops in Queens

#### Pick-up Only

Myrtle Av & 73 St  
Myrtle Av & 71 Pl  
Myrtle Av & 68 St  
Myrtle Av & Cypress Hills St  
Myrtle Av & Fresh Pond Rd  
Fresh Pond Rd & Catalpa Av  
Fresh Pond Rd & Putnam Av  
Fresh Pond Rd & Gates St  
Fresh Pond Rd & Metropolitan Av  
Eliot Av & Fresh Pond Rd  
Eliot Av & 69 St  
Eliot Av & 74 St  
Eliot Av & 77 Pl  
Eliot Av & 80 St  
Eliot Av & 83 Pl  
Eliot Av & 85 St

### Stops in Manhattan

#### (6 Av Stops)

#### Drop-off Only

34 St & 3 Av  
34 St & Park Av  
34 St & 5 Av  
6 Av & 35 St  
6 Av & 37 St  
6 Av & 43 St  
6 Av & 50 St  
6 Av & 56 St  
57 St & Madison Av  
57 St & 3 Av

## QM24 Bus Stops to Glendale

### Stops in Manhattan

#### (6 Av Stops)

#### Pick-up Only

34 St & 3 Av  
34 St & Park Av  
34 St & 5 Av  
6 Av & 35 St  
6 Av & 37 St  
6 Av & 43 St  
6 Av & 50 St  
6 Av & 56 St  
57 St & Madison Av  
57 St & 3 Av

### Stops in Queens

#### Drop-off Only

Eliot Av & 85 St  
Eliot Av & 83 Pl  
Eliot Av & 80 St  
Eliot Av & 77 St  
Eliot Av & 74 St  
Eliot Av & 69 St  
Fresh Pond Rd & Eliot Av  
Fresh Pond Rd & Metropolitan Av  
Fresh Pond Rd & Linden St  
Fresh Pond Rd & Madison St  
Fresh Pond Rd & Catalpa Av  
Fresh Pond Rd & Myrtle Av  
Myrtle Av & Cypress Hills St  
Myrtle Av & 69 St  
Myrtle Av & 72 St  
Myrtle Ave & 73 Pl

## QM34 Bus Stops to Manhattan

### Stops in Queens

#### Pick-up Only

Myrtle Av & 73 St  
Myrtle Av & 71 Pl  
Myrtle Av & 68 St  
Myrtle Av & Cypress Hills St  
Myrtle Av & Fresh Pond Rd  
Fresh Pond Rd & Catalpa Av  
Fresh Pond Rd & Putnam Av  
Fresh Pond Rd & Gates St  
Fresh Pond Rd & Metropolitan Av  
Eliot Av & Fresh Pond Rd  
Eliot Av & 69 St  
Eliot Av & 74 St  
Eliot Av & 77 Pl  
Eliot Av & 80 St  
Eliot Av & 83 Pl  
Eliot Av & 85 St

### Stops in Manhattan

#### (3 Av Stops)

#### Drop-off Only

3 Av & 38 St  
3 Av & 44 St  
3 Av & 50 St  
3 Av & 55 St

## QM34 Bus Stops to Glendale

### Stops in Manhattan

#### (3 Av Stops)

#### Pick-up Only

3 Av & 38 St  
3 Av & 44 St  
3 Av & 50 St  
3 Av & 55 St

### Stops in Queens

#### Drop-off Only

Eliot Av & 85 St  
Eliot Av & 83 Pl  
Eliot Av & 80 St  
Eliot Av & 77 St  
Eliot Av & 74 St  
Eliot Av & 69 St  
Fresh Pond Rd & Eliot Av  
Fresh Pond Rd & Metropolitan Av  
Fresh Pond Rd & Linden St  
Fresh Pond Rd & Madison St  
Fresh Pond Rd & Catalpa Av  
Fresh Pond Rd & Myrtle Av  
Myrtle Av & Cypress Hills St  
Myrtle Av & 69 St  
Myrtle Av & 72 St  
Myrtle Ave & 73 Pl

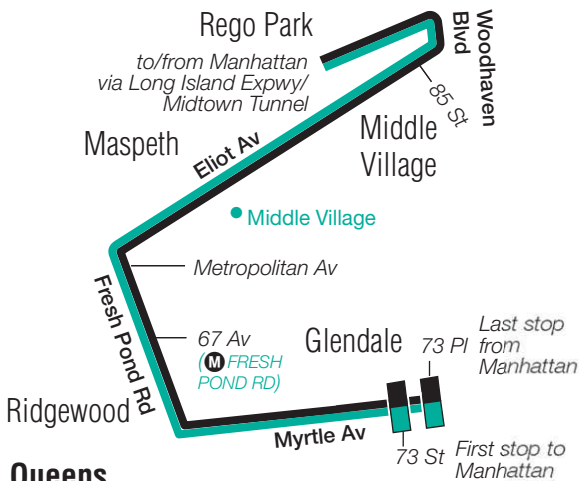

## Queens

## Manhattan

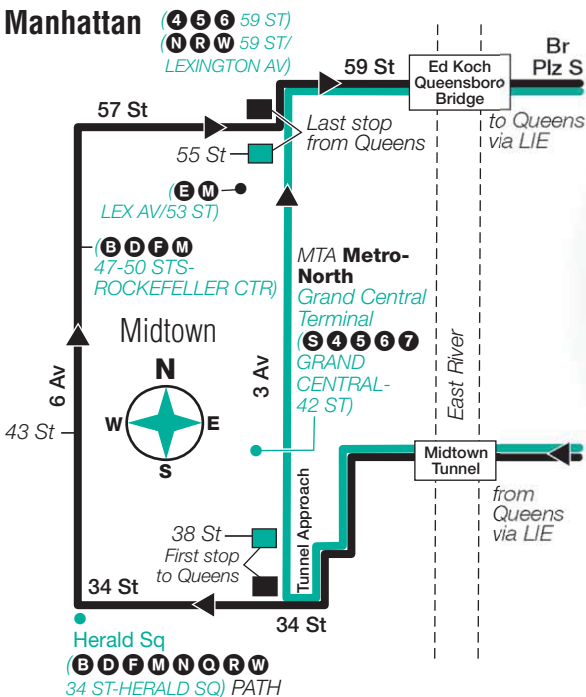

## QM24/QM34 MAP LEGEND

- QM24 Terminal
- QM34 Terminal
- QM24 6 Av Service
- QM34 3 Av Service
- (6 STATION NAME) Subway Connection
- MTA **Metro-North** Railroad Station
- Point of Interest

For Accessible subway stations, travel directions and other information:

Call 511 or visit [www.mta.info](http://www.mta.info)